

Drawing number 10-ITS-TH-02-003															
Name															
<ul style="list-style-type: none"> Existing carrageway Proposed carrageway widening Proposed footway alterations Proposed shared footway/cycleway Traffic island 															
<table border="1"> <tr> <th>Rev</th> <th>Number</th> <th>Date</th> <th>Purpose of revision</th> <th>Drawn</th> <th>Checked</th> <th>App'd</th> </tr> <tr> <td> </td> <td> </td> <td> </td> <td> </td> <td> </td> <td> </td> <td> </td> </tr> </table>	Rev	Number	Date	Purpose of revision	Drawn	Checked	App'd								<p>Kent Highways Services</p> <p>East Kent Division Ashtford Highway Depot, Javelin Way, Ashtford, Kent, TN24 5AD Tel: 01853 217 600</p> <p>Project WESTWOOD TRANSPORT PLAN</p> <p>Drawing title WESTWOOD ROAD IMPROVEMENTS WITH BUILDER CENTRE LAND PRELIMINARY LAYOUT SHEET 1 OF 3</p> <p>Drawing status FOR CONSULTATION</p> <p>Scale 1:500 at A3</p> <p>Drawing number 10-ITS-TH-02-003</p> <p>Rev 0</p>
Rev	Number	Date	Purpose of revision	Drawn	Checked	App'd									

This drawing is not to be used for tender or part other than for the intended purpose and project as defined in the contract. It is the client's responsibility to ensure that all drawings are up to date.

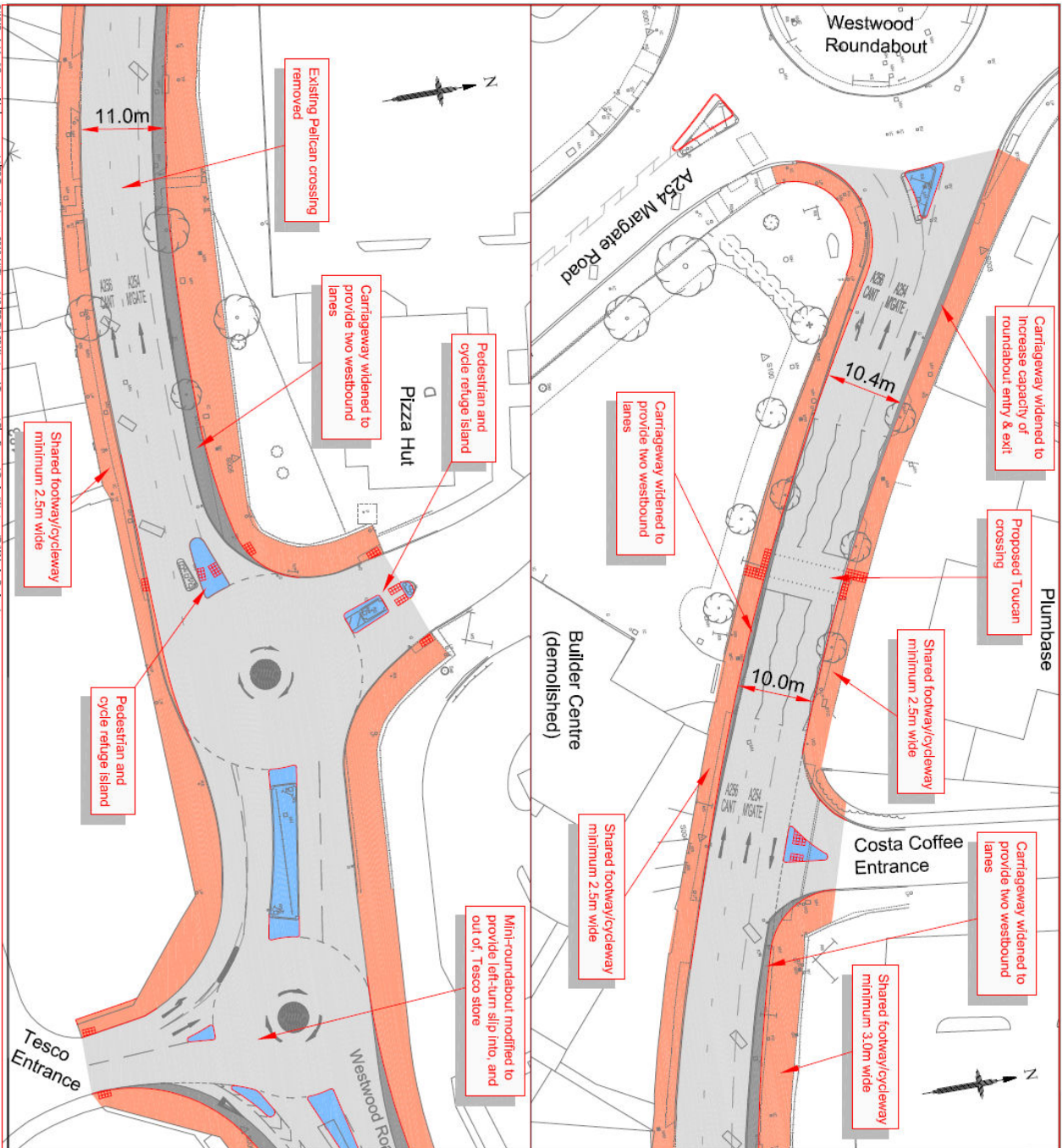

S:\Projects - National\Countywide Improvements\10-ITS-TH-02-004 Westwood Transport Plan Format Design\Westwood\10-ITS-TH-02-004.dwg

Drawing number	10-ITS-TH-02-004												
Name													
<table border="0" style="width: 100%;"> <tr> <td style="width: 20px; height: 20px; background-color: #cccccc;"></td> <td>Existing carriageway</td> </tr> <tr> <td style="width: 20px; height: 20px; background-color: #999999;"></td> <td>Proposed carriageway widening</td> </tr> <tr> <td style="width: 20px; height: 20px; background-color: #ffff00;"></td> <td>Proposed footway alterations</td> </tr> <tr> <td style="width: 20px; height: 20px; background-color: #ff9900;"></td> <td>Proposed shared footway/cycleway</td> </tr> <tr> <td style="width: 20px; height: 20px; background-color: #99ccff;"></td> <td>Traffic island</td> </tr> </table>					Existing carriageway		Proposed carriageway widening		Proposed footway alterations		Proposed shared footway/cycleway		Traffic island
	Existing carriageway												
	Proposed carriageway widening												
	Proposed footway alterations												
	Proposed shared footway/cycleway												
	Traffic island												
Rev	Revision Date	Purpose of revision	Drawn / Checked / App'd										
East Kent Division Ashford Highway Dept, Javelin Way, Ashford, Kent TN24 7BQ Tel. 01622 247 800													
Project: WESTWOOD TRANSPORT PLAN													
Drawing title: WESTWOOD ROAD IMPROVEMENTS WITHIN HIGHWAY BOUNDARIES PRELIMINARY LAYOUT SHEET 1 OF 3													
Drawing status: FOR CONSULTATION													
Scale	1:500 at A3	Do not scale											
Drawing number	10-ITS-TH-02-004												
Rev	0												

This drawing is not to be used in whole or part other than for the intended purpose and project as defined on this drawing. Refer to the contract for all terms and conditions.

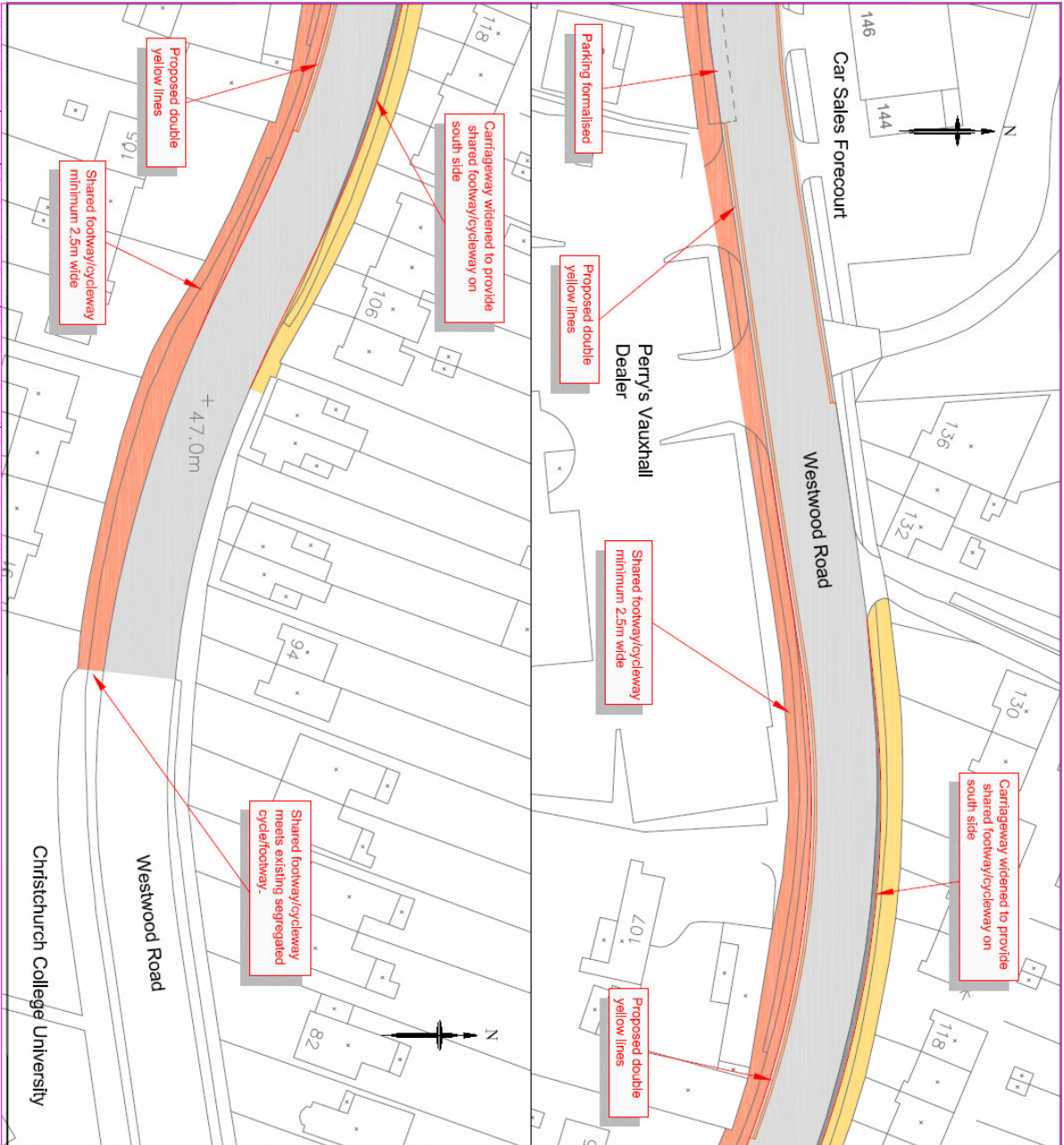

Drawing number
10-ITS-TH-02-006

- Notes
- Existing carriageway
 - Proposed carriageway widening
 - Proposed footway alterations
 - Proposed shared footway/cycleway
 - Traffic island

Rev	Revised Date	Purpose of revision	Drawn	Checked	App'd



East Kent Division
 Auldon Highway Depot, Javelin Way,
 Auldon, Kent ME24 5AD
 Tel: 01622 211 630

Project
WESTWOOD TRANSPORT PLAN

Drawing title
WESTWOOD ROAD IMPROVEMENTS

PRELIMINARY LAYOUT
 SHEET 3 OF 3

Drawing status
FOR CONSULTATION

Scale
1:500 at A3

Drawing number
10-ITS-TH-02-006

Rev	
0	

This drawing is not to be used in whole or part other than for the intended purpose and project as defined on this drawing. Refer to the contract for all terms and conditions.